

Floor Area
104.6 m²

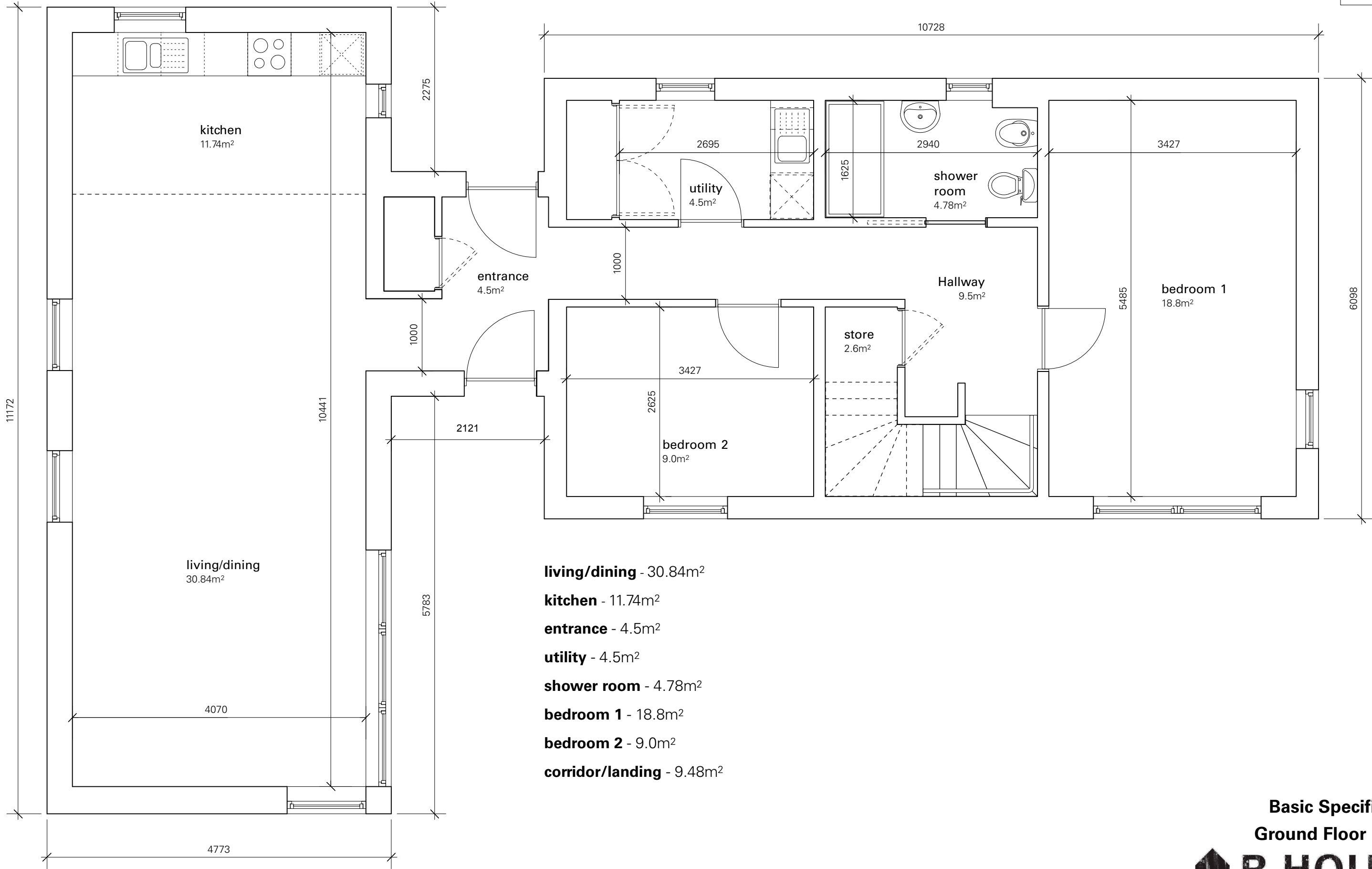

- living/dining** - 30.84m²
- kitchen** - 11.74m²
- entrance** - 4.5m²
- utility** - 4.5m²
- shower room** - 4.78m²
- bedroom 1** - 18.8m²
- bedroom 2** - 9.0m²
- corridor/landing** - 9.48m²

R4L
Basic Specification
Ground Floor Layout
R.HOUSE

6A Drynoch, Crossal, Isle of Skye, IV47 8SP
tel 01478 612 899 sales@ruralhouse.net